



# MX4 Houseboat MOAT

€649,000 • Nieuwbouw Poland • New • 2024

## Presented by

Sjoerd Kampen  
Phone: 0031(0)6-54723943

## Scheepsmakelaardij Goliath

Hendrik Bulthuisweg 2  
8606 KB SNEEK  
Netherlands



## Details

Make:	MX4 Houseboat
Model:	MOAT
Year:	2024
Condition:	New
Engine type:	
Length:	13.15 m (43.14 ft)
Beam:	5.4 m (17.72 ft)
Cabins:	0
Berths:	0



Scheepsmakelaar  
dij Goliath



7zea.com

# Description

EN

Steel monohull with a split-level floor

Good sailing steel or aluminum ship. The split-level creates a nice big roof terrace where the steering position has a good overview of the ship. The drive is electric, but you can also get a non-sailing version.

NL

Stalen monohull met een split-level vloer

Goed varende stalen of aluminium schip. Door de split-level ontstaat een mooi groot dakterras waarop de stuurstand een goed overzicht heeft over het schip. De aandrijving is elektrisch, maar u kunt ook een niet varende versie krijgen.

**Voor meer informatie neem contact op met: Terry Bos +31 (0) 641470689 of [terry@scheepsmakelaardijgoliath.nl](mailto:terry@scheepsmakelaardijgoliath.nl)**

## Accommodatie

Slaapplaatsen: Vast:4, extra:2.

DE

Stahl-Monoschiff mit Split-Level-Boden

Gut segelndes Stahl- oder Aluminiumschiff. Durch die Split-Ebene entsteht eine schöne große Dachterrasse, auf der der Steuerstand einen guten Überblick über das Schiff hat. Der Antrieb ist elektrisch, aber Sie können auch eine nicht segelnde Version bekommen.

FR

Monocoque en acier avec un plancher à deux niveaux

Bon navire en acier ou en aluminium. Le split-level crée une belle et grande terrasse de toit sur laquelle le poste de pilotage a une bonne vue d'ensemble du navire. La propulsion est électrique, mais vous pouvez également obtenir une version sans voile.

## General information

Make:	MX4 Houseboat
Model:	MOAT
Year:	2024
Condition:	New
Engine type:	

## Measurements

Length:	13.15 m (43.14 ft)
Beam:	5.4 m (17.72 ft)
Deep:	0.65 m (2.13 ft)

## Accommodation

Cabins:	0
Berths:	0

# Images





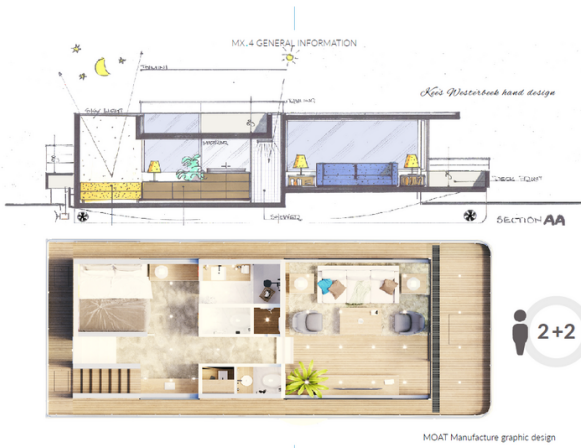
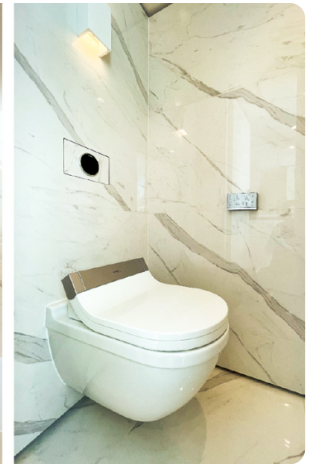

MX.4 PERFORMANCE

Steerable E-Pod	
Engine Type	Electric, BLDC
Voltage	48V
kWatt	<30kW
Cooling system	Air cooled
Torque	up to 130Nm
Motor RPM	1900/RPM
Controller	NMEA2000
Maximum speed	11 km/h

Inboard E-propulsion	
Engine Type	Electric, BLDC
Voltage	144V
kWatt	>30kW
Cooling system	Liquid cooled
Torque	from 220Nm
Motor RPM	1500/RPM
Controller	NMEA2000
Maximum speed	12 km/h

MX.4 GENERAL INFORMATION



MX.4 CRUISING

Length: 10.15m  
 Beam: 5.40m  
 Draft: ± 0.65m  
 Weight: ± 24t  
 CE design: D  
 Propulsion: Electric

STEEL MONOHULL

Marine grade steel alloy #6mm  
 Watertight fore peak bulkhead  
 Split-level floor construction  
 Hempel® advanced paint system  
 DNV-GL approved solutions

CAPACITY

12 persons  
 2400 kg  
 78 m²

MX.4 PERFORMANCE

100% ELECTRIC

The performance you expect.

Houseboating is not about speed, yet it brings excitement when you know that there is always enough power to perform. Your MX.4 could be equipped with a selected range of high torque, eco-friendly, electric engines that give you instant performance, low CO<sub>2</sub> emission and better handling. Whichever option you may select, the MX.4 articulates a clear expression of uncompromising performance, confidence and safety. Always available.

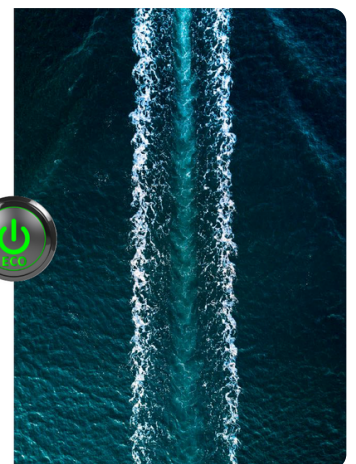

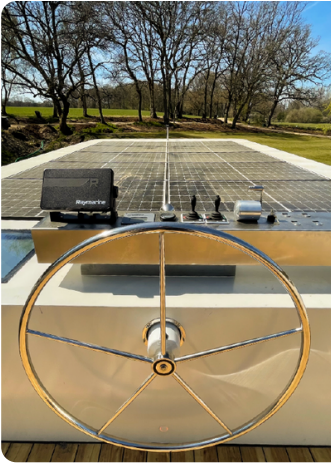

MX.4 PERFORMANCE



**Steerable E-Pod**

Engine Type Electric, BLDC  
 Voltage 96V  
 kWatt 430kW  
 Cooling system Air cooled  
 Torque Up to 130Nm  
 Motor RPM 1900 RPM  
 Controller NIVEA2000  
 Maximum speed 11 km/h



**Inboard E-propulsion**

Engine Type Electric, BLDC  
 Voltage 144V  
 kWatt 430kW  
 Cooling system Liquid cooled  
 Torque from 220Nm  
 Motor RPM 1500 RPM  
 Controller NIVEA2000  
 Maximum speed 12 km/h



**Scheepsmakelaardij Goliath**

Hendrik Bulthuisweg 2

8606 KB SNEEK

Netherlands

Phone: 0031(0)6-54723943

<https://www.scheepsmakelaardijgoliath.nl>

